

Gateway Frame Relay Series

JBM Electronics' Gateways are low-cost routers designed for users who need to interface Legacy protocol devices to a Frame Relay network. The Gateways provide:

- One multi-protocol serial port
- One 10/100BaseT port
- One console port

The Gateway DSU support is:

- G700 supports an external DSU
- G800 provides a 56/64/72 KB DSU
- G900 provides a Fractional-T1 DSU

The Gateways convert Legacy protocols to TCP/IP or UDP for connection to a Frame Relay network. The Gateways can also interface IP-only devices to a Legacy protocol network. Terminal emulation for the IP device is available, providing a unique migration path for a network. This capability allows an IP device to coexist with an older protocol network.

Applications

The Gateways offer several advantages in customer networks, including:

- Converts data from Legacy protocol devices to TCP for connection to a WAN network, providing a migration path to an IP-based network.
- Allows TCP/IP devices to access a Legacy protocol network.

- Provides host and terminal emulation for all polled protocols, which allows up to 100 physical devices to be connected to one serial port.
- Converts data from a TCP/IP device to UDP for Ethernet networks.
- Provide secure communications with SSL, IPSec encryption and VPN tunneling software.
- Offers intrusion protection with an integrated Stateful Inspection Firewall.
- Provides full Frame Relay support and complete control over the frame network interface, including Priority and CIR allocation.
- Provides X.25 support with any combination of PVCs and SVCs.
- Simplifies network design and integration with a wide range of connection options coupled with the integrated security.
- Provides special support software for ATMs and POS devices to enhance error reporting and recovery.
- Offers RIP, OSPF and BGP routing for IP data.
- Offers custom modifications to handle unique user requirements, such as text or data manipulation, special log-in commands, host application messages, or data translations.

Benefits

The Gateway simplifies network design by eliminating the need for network changes to handle Legacy protocols. The conversion eliminates the need for a separate network for the legacy protocol and protects the investment in Legacy devices when moving to an IP network. The Gateway can help protect the investment in Legacy devices when moving to a new network.

Protocol Support

The Gateways support many standard LAN, WAN and serial protocols, including:

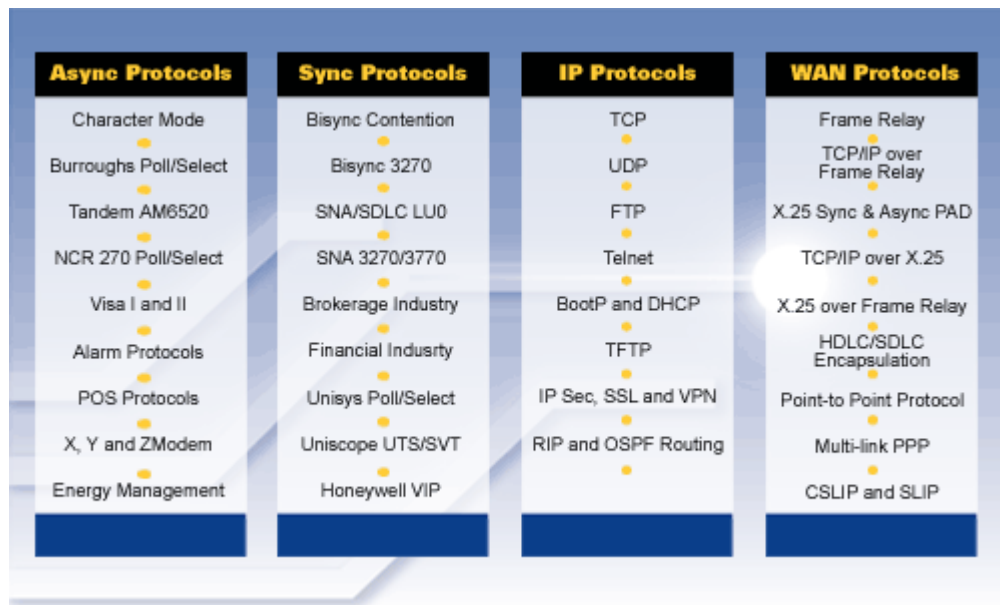

The Gateway’s protocol support includes local polling (spoofing) of attached devices and Client and Server support for the IP protocols.

Security

The Gateways provides an integrated suite of security modules which offer protection from outside attack and preserve the integrity of the data. The modules include a Firewall, SSL, IPSec and VPN Client, NAT and DHCP Servers. The Gateway uses a straight-forward system to implement and configure the individual modules.

Network Diagram

This drawing illustrates a configuration using a G700. All of the Gateways provide the same IP connectivity; the only difference is the number of serial and Ethernet devices that can be attached.

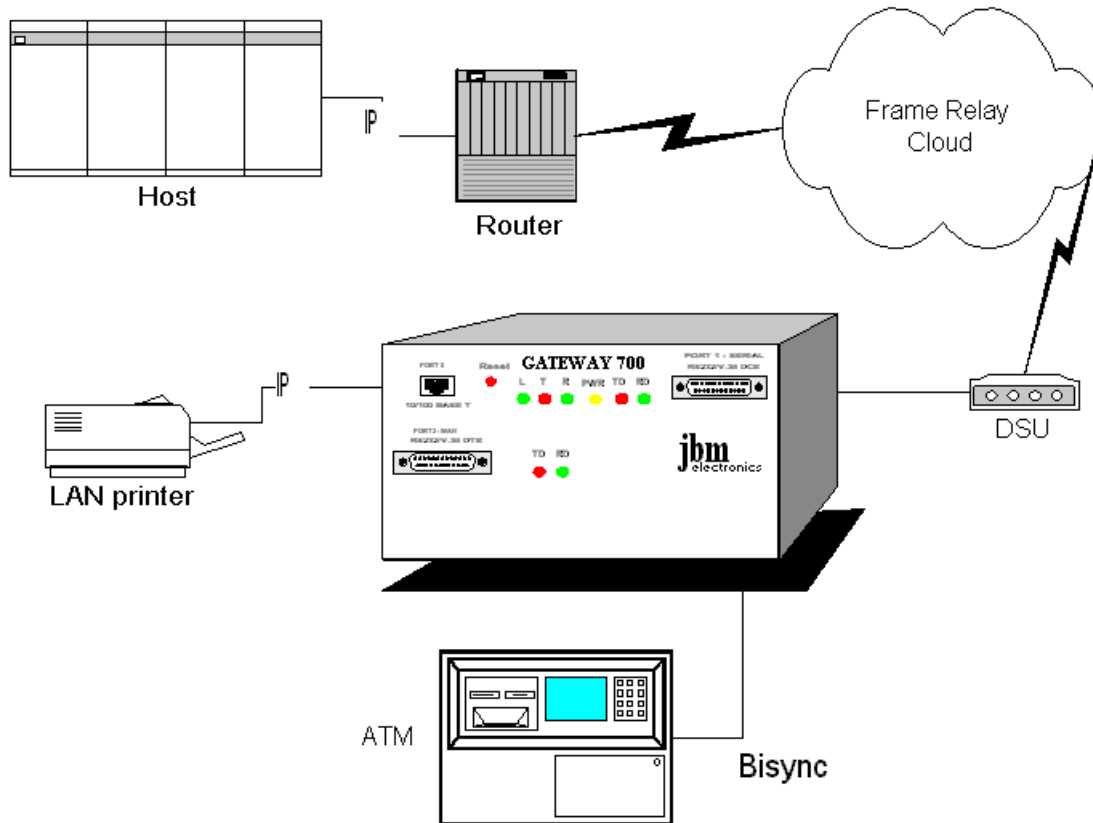

The Gateways can be ordered with Frame Relay connections using an internal or external DSU. The Gateway 800 provides the same port configuration as the G700 but has an integrated 56 KB DSU. The Gateway 900 provides an integrated T1/E1 DSU. With the frame connection, the Gateways provide a complete router replacement with full protocol conversion.

The Gateway's security software can be used to protect attached devices from unauthorized access or establish a Virtual Private Network (VPN) to connect separate locations into a secure network using Internet connections.

Diagnosics

The Gateways can be configured through CLI commands entered via Telnet interface. The Telnet connection provides command and control of the Gateway. SNMP Traps provide notification of major events in the Gateway. All of the protocol-specific diagnostics, such as LUSTATS, Notify, and Status and Sense Bytes are supported. Extensions to the Telnet or SNMP commands are available as a special order.

Frame Relay Support

The Gateways provides full support for Frame Relay networks, including:

- Supports up to 100 Logical Channels (DLCIs).
- Both CPE and Access Node configurations.
- ANSI T1.617 Annex D, Q.933 or LMI Local Signaling.
- Frame Size to 4096 Bytes.
- Flow control using individual Committed Information Rate (CIR) for each DLCI.

Our Frame Relay support is certified to ISO and ITU standards by major network laboratories. The X.25 support is certified to European NET2 standards by the ROLAND Laboratory.

The Gateways are available with support for an external DSU (G700) or with a 56/64/72 KB DSU (G800) or Fractional-T1 internal DSU (G900).

Gateway Specifications

Serial Port:	Baud Rate:	110-56,000 bps
	Interface:	One Female DB-25 connector (G700), RS-232C/V.35, DCE mode, DTE mode with adapter cable
WAN Port: G700	Baud Rate:	Up to T1/E1 Speeds (1.544 - 2.088 Mbps)
	Interface:	One Female DB-25 connector, RS-232C/V.35/X.21/EIA 530, DTE mode, DCE mode with adapter cable
WAN Port: G800	Baud Rate:	56/64/72 KB DSU
	Interface:	One Female RJ-45 connector
WAN Port: G900	Baud Rate:	Fractional T1/E1 (1.544 - 2.088 Mbps)
	Interface:	One Female RJ-45 connector
LAN Port:	Ethernet:	10/100BaseT
		One Female RJ-45 connector
Console Port:	Baud Rate:	Up to 115,200 bps
	Interface:	One Male DE-9, RS-232C DTE mode DCE mode with adapter cable
Management:	Console Port:	CLI Access through async connection
	IP Protocol	SNMP and Telnet or SSH
LED Indicators:	Serial Port(s):	TD and RD (each port)
	WAN Port:	TD and RD
	LAN Port:	Link, Transmit, Receive (each port)
	Power:	On/Off State
Power:	120-240 VAC, 50/60 Hz (Internal)	
Physical:	Size:	6.5" W x 3.5" H x 10" L
	Weight:	5 pounds
Processor:	486DX-100	
Memory:	32 MB RAM, 128 K BRAM, 16MB Flash	
Warranty:	1 Year Parts and Labor	

The Gateways are listed by a NRTL to UL 1950 standards, meets FCC Class A regulations and complies with the CE Statement for the European Low Voltage Directive 73/23/EEC.

The Gateways are part of JBM Electronics' Gateway family of communication devices. The Gateway provides support for many LAN and WAN protocols in a variety of different levels of functionality. A wide variety of expansion options are available for the Gateway. Contact JBM Electronics for details.

Prices and specifications are subject to change without notice.